

# BLUFFSIDE PARK

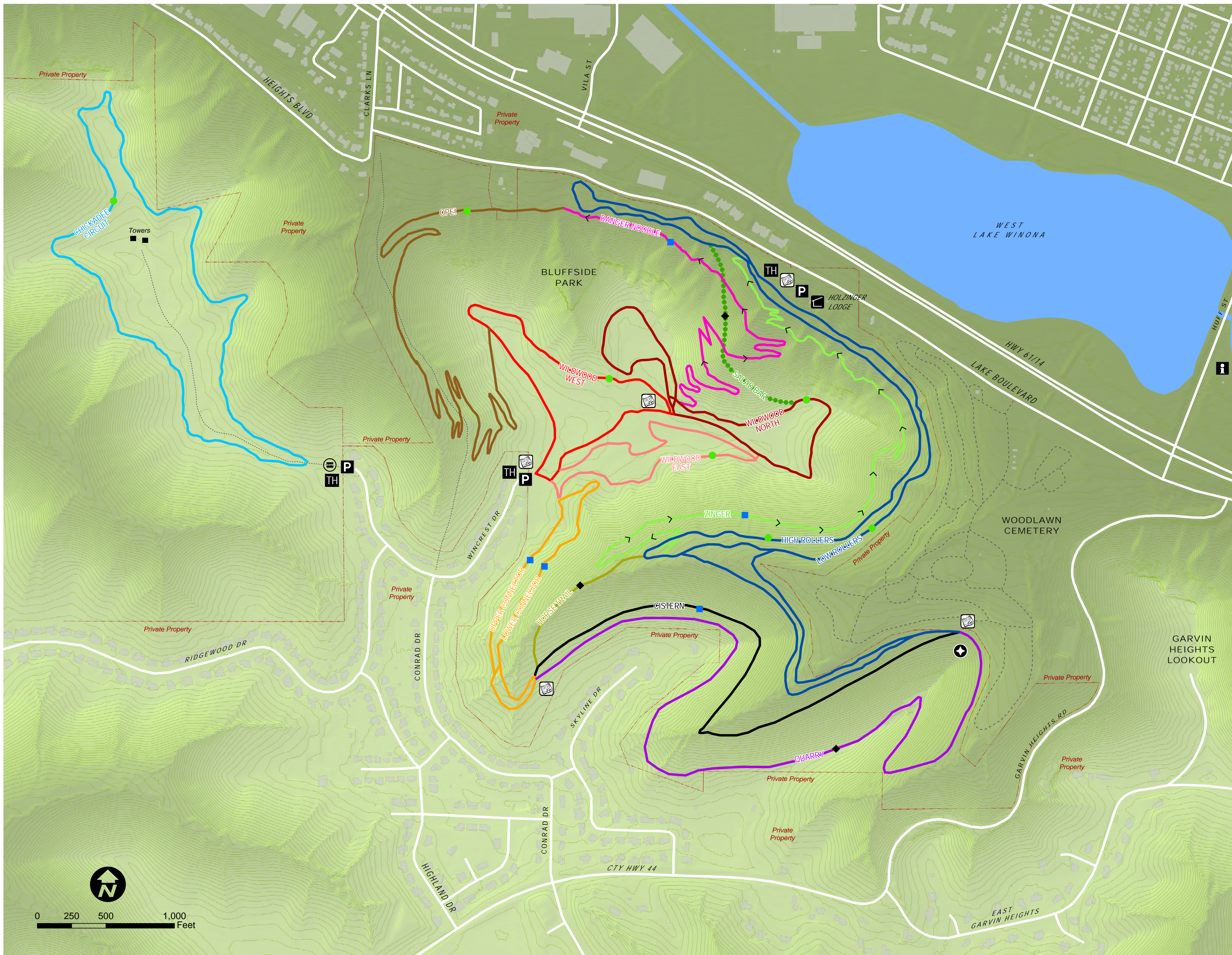

## LEGEND

- VISITOR CENTER
- TRAILHEAD
- GATE
- PARK SHELTER
- PARKING
- CISTERN
- MAP
- CEMETERY ROAD
- UTILITY ACCESS ROAD
- 10' CONTOURS

## BLUFFSIDE TRAILS

OPE! (1.53 mi)	
DANGER NOODLE (1.00 mi) Mountain Bike Only - ONE WAY	
ZINGER (1.27 mi) Mountain Bike Only - ONE WAY	
CHICKADEE CIRCUIT (1.58 mi)	
CISTERN (.91 mi)	
HORSE TRAIL (.24 mi)	
HIGH ROLLERS (1.17 mi) LOW ROLLERS (1.36 mi)	
QUARRY (1.35 mi)	
SALAD BAR (.28 mi) Hiking Only	
UPPER CONNECTOR (.39 mi) LOWER CONNECTOR (.47 mi)	
WILDWOOD EAST (.72 mi)	
WILDWOOD WEST (.86 mi)	
WILDWOOD NORTH (.96 mi)	

## TRAIL LEVEL

- Easy More Difficult Very Difficult
- All trails are multi-use unless otherwise noted.

Trails maintained by:

